

OREGON CORNER RESTORATION FORM

Section 25 Township 5N Range 36E
County Umatilla Date: April 26th, 2025

Corner Designation: 5N36V25

Corner common to sections 25 and 36, T5N, R36E &
Sections 30 and 31, T5N, R37E, W.M., Umatilla County,
Oregon.

Condition report only
Not Found
☒ Remonumented
☐ Unrecorded
☐ Surveyed In
☒ Referenced Out

Previous Renewals, Surveys, etc...

This corner was originally set by U.S. Deputy Surveyor Odell and Lewis under GLO contract 110 dated February 7th 1865. Their record reads: Set post Cor. for Secs. 25, 36, 31, & 30. Drove Charred Stake; Dug pits & raised mound, as per instructions. In the Record of Private Surveys No. 99, Dated June of 1898, County Surveyor John Kimbrell stated "set stone in mound of stone at foot of verticle ledges of rock 50 feet high for corner to secs 30, 31, 25 & 36.

Monument and accessories found: (condition and source)

Found a 2" Aluminum cap on a 5/8" x 15" Iron Rebar in a rock jack mound of stone with fences south and west at the foot of a bluff. The cap was stamped with a center punched triangle and the letters USKH. There was no survey on record for this monument.

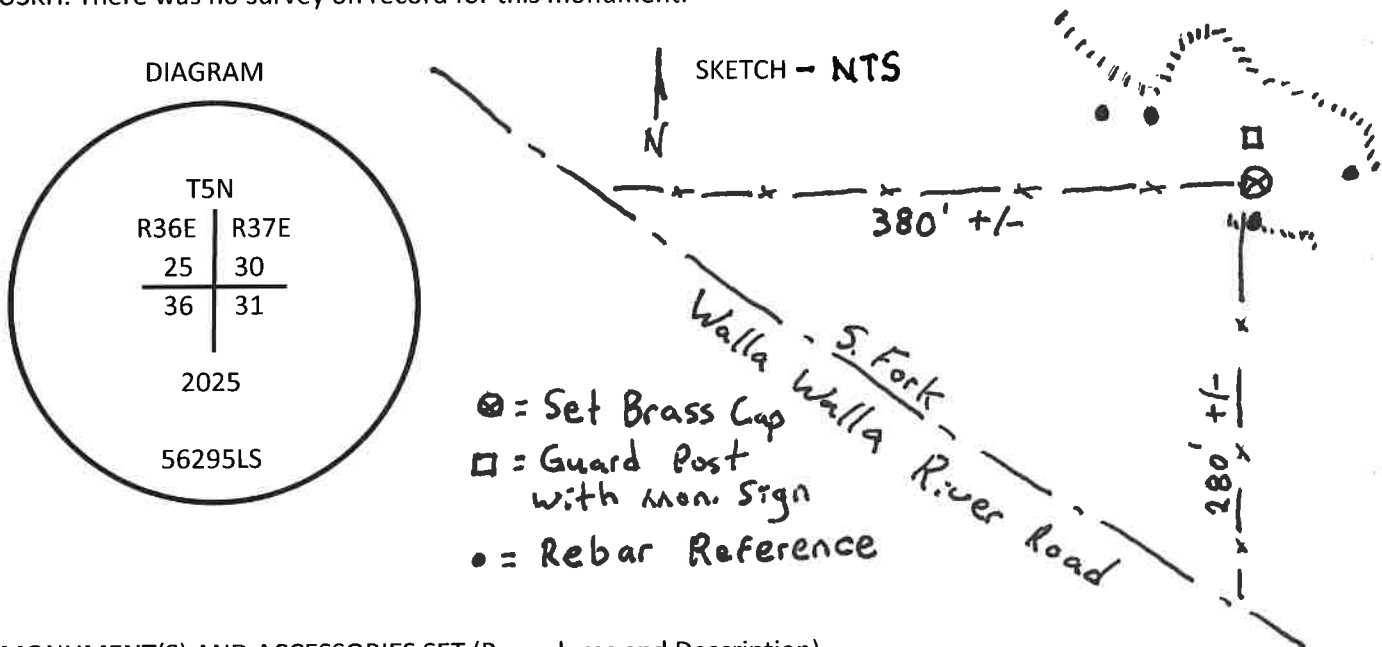

MONUMENT(S) AND ACCESSORIES SET (Procedures and Description)

At the position of the aluminum cap I set a 1 1/2" x 30" galvanized iron pipe with a 2 1/2" brass cap attached stamped as shown in the diagram above 20" in the ground to bedrock. Built a 2 ft. diameter mound of stone 8 inches tall around the monument.

For references I set four 5/8" by 24" iron rebars with 1.25" orange plastic caps stamped WTS and 56295LS as described below:

An iron rebar bears S42°47'08"E, 17.72 feet in a crack in the rimrock;
An iron rebar bears S06°11'07"W 8.72 feet in a crack in the rimrock;
An iron rebar bears N58°49'39"W 33.68 feet in a crack in the rimrock;
An iron rebar bears N58°51'43"W 60.56 feet in a crack in the rimrock;

The monument was tied using a Trimble R8S RTK GPS Base - Rover pair.

Location and comments:

Compass Declination

Firm / Agency

Witness Tree Surveying

Address

P.O. Box G

Pilot Rock, OR 97868

Party Chief

Stephen K. Haddock

Surveyor's Seal

REGISTERED
PROFESSIONAL
LAND SURVEYOR

Stephen K. Haddock

OREGON
JULY 9, 2001
STEPHEN K. HADDOCK
56295LS

RENEWS: 6-30-27

RECEIVED BY:

Umatilla County Surveyor

Date: 3/20/23

Rec'd By: CT

23-024-C