

OREGON CORNER RESTORATION FORM

Section 25 Township 5N Range 36E
County Umatilla Date: 23-Apr-25

Corner Designation: 5N36V23 Condition report only
Not Found
X Remonumented
Unrecorded
Surveyed In
X Referenced Out

Previous Renewals, Surveys, etc...
This corner was originally set by Odell and Lewis under GLO contract 110 dated February 7th, 1865. Their record reads: Set 1/4 Sec. post, on E. side of steep hill, one chain from summit. In the record of private surveys, survey 99 dated June 24, 1898, County Surveyor John Kimbrell states "set stone in mound of stone for 1/4 sec. cor.

Monument and accessories found: (condition and source)
None. The point falls on steep north slope of about 70%. There is no hint of the summit mentioned by Odell & Lewis.

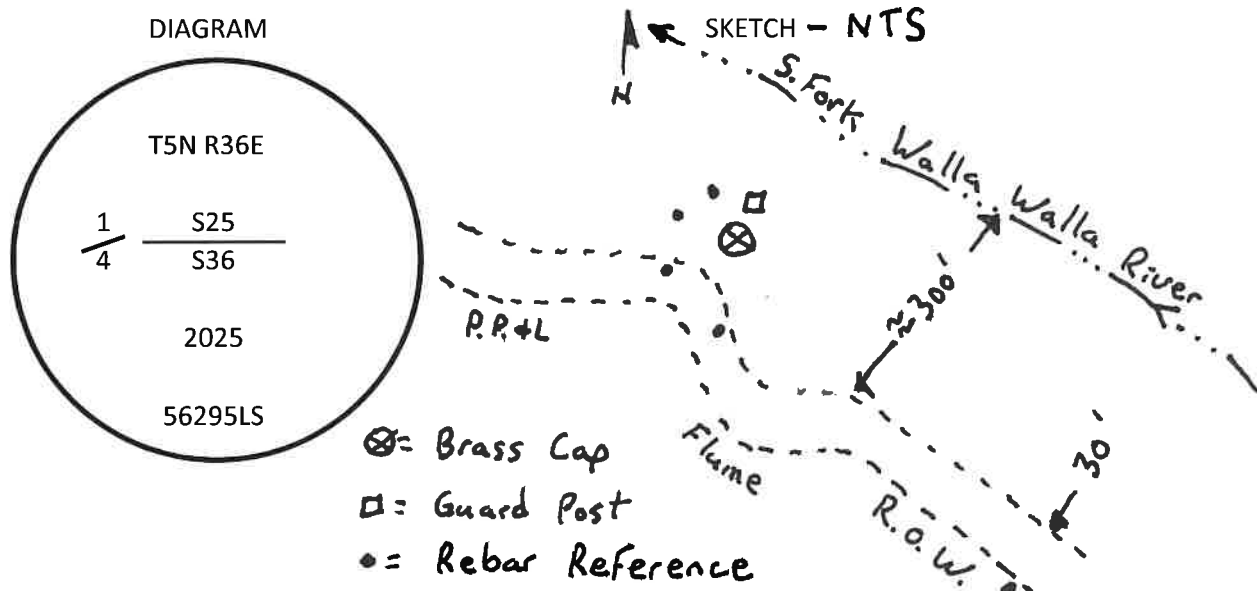

MONUMENT(S) AND ACCESSORIES SET (Procedures and Description)
I first calculated the intersection of the section line with the centerline of the P, P, & L flume race using the line and distance data as shown on the Walla Walla River Power Canal map PD-1015 dated June, 1911. The corner point falls on the section line 64.9' east of this intersection where I set a 1 1/2" x 30" galvanized iron pipe with a 2 1/2" brass cap attached 17" in the ground with a 3 foot mound of stone to the top of the cap. The cap is stamped as shown in the diagram above.

For references I set four 5/8" by 24" iron rebars with 1.25" orange plastic caps stamped WTS and 56295LS as described below:

- An iron rebar bears N27°47'36"W, 11.95 feet flush with the surface;
- An iron rebar bears N76°36'48"W, 18.52 feet flush with the surface;
- An iron rebar bears S56°42'48"W 29.02 feet in the north shoulder of the flume race;
- An iron rebar bears S03°57'45"W 39.69 feet in the north shoulder of the flume race;

The monument was tied using a Trimble R8S RTK GPS Base - Rover pair.

Location and comments:

Compass Declination

Firm / Agency
Witness Tree Surveying
Address
P.O. Box G
Pilot Rock, OR 97868
Party Chief
Stephen K. Haddock

Surveyor's Seal
REGISTERED PROFESSIONAL LAND SURVEYOR
Stephen K. Haddock
OREGON
JULY 9, 2001
STEPHEN K. HADDOCK
56295LS
RENEWS: 6-30-27

RECEIVED BY:
Umatilla County Surveyor
Date: 3/20/23
Rec'd By: CT
23-024-C